

XTF™



XIP Series

Chemical Pumps According to ISO 2858 / 5199

XIP Series (I-IV)

Chemical Pumps According to ISO 2858/5199 Standards

XTF Corporation is a centrifugal pump manufacturer located in Greensboro, North Carolina, U.S.A.. Being one of the leading forces in the global industrial pump marketplace, we provide in-depth expertise in pre-engineered, engineered, and special purpose pumping solutions and systems.

The XTF™ I Series pumps provide superior hydraulic performance for chemical applications, including:

- *Chemical and petrochemical processing*
- *Food and beverage processing*
- *Hydrocarbon processing*
- *Sea water and wastewater treatment*
- *Brine*
- *Polymers / solvents*
- *Pulp and paper*
- *Primary metals*
- *Pharmaceutical*
- *Acid transfer*
- *Corrosive services*

Range of Coverage:

- *Maximum capacity: 4,750gpm (1,079m³/h)*
- *Maximum head: 492ft (150m)*
- *Temperature: -40°F to +356°F (-40°C to +180°C)*
- *Maximum Pressure: 235psi (1,620kPa)*

Technical Specifications, Features and Benefits:

- *Pump dimensions of XIP series conform to ISO 2858 and ISO 5199 design criteria.*
- *Easy interchangeability with other ISO 2858 compliant pumps.*
- *Single-stage pumps with overhung impellers, volute casings, axial suction, and radial discharge.*
- *Available in closed impeller construction for higher efficiency.*
- *Wide range of models and MOCs available covering the maximum duty conditions.*
- *Back pull-out design allows removal of rotating element without removing casing, piping, or motor.*
- *Stuffing box dimension permits the interchangeability between packing and standard mechanical seals (the standard construction uses mechanical seals according to DIN but most mechanical seals are suitable for construction).*
- *Robust shaft and bearing designs minimize shaft deflection and extend mechanical seal and bearing life.*
- *Case iron bearing housing is designed for safety, strength, interchangeability, and retrofit capability.*

Performance Characteristics

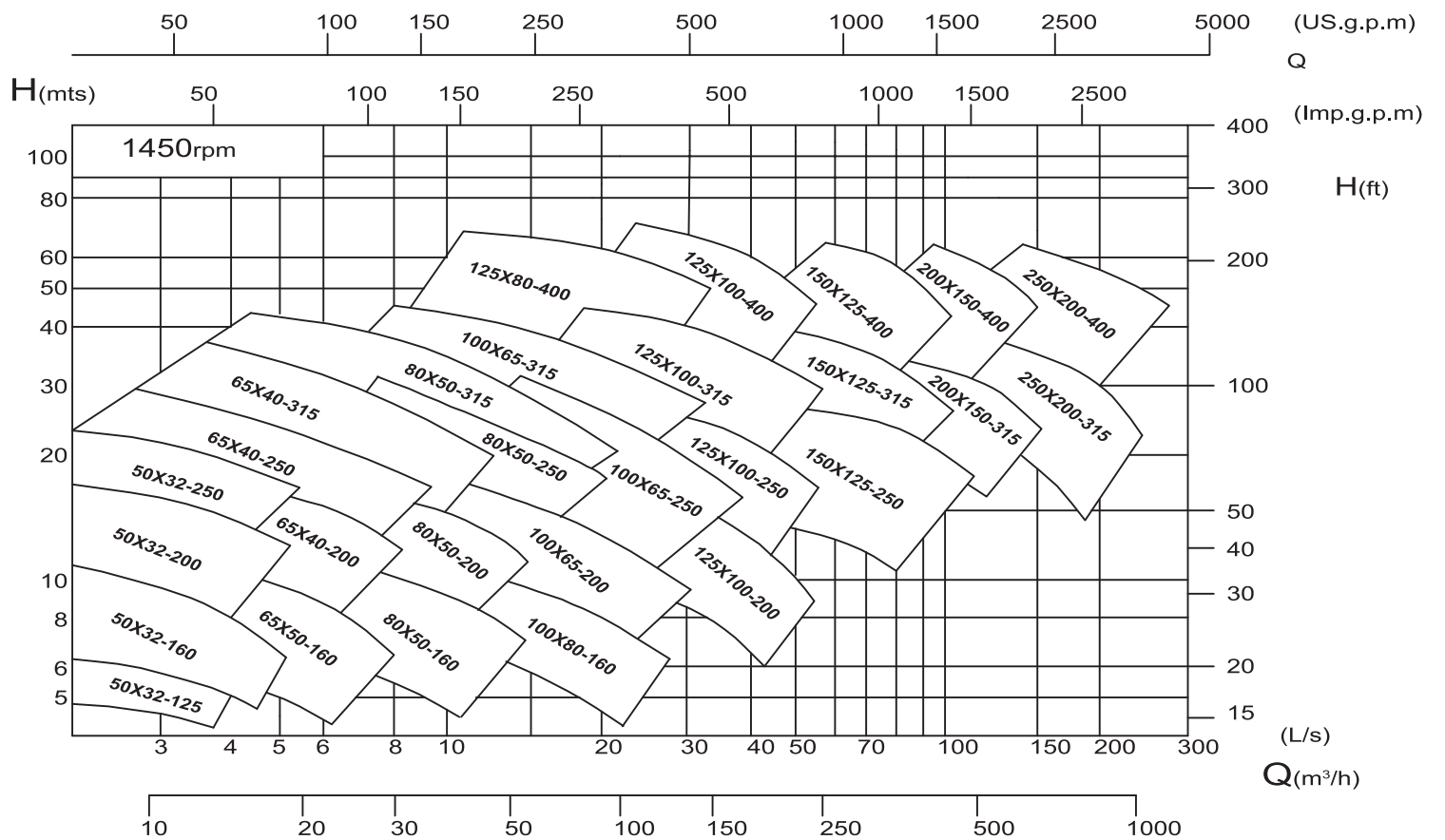
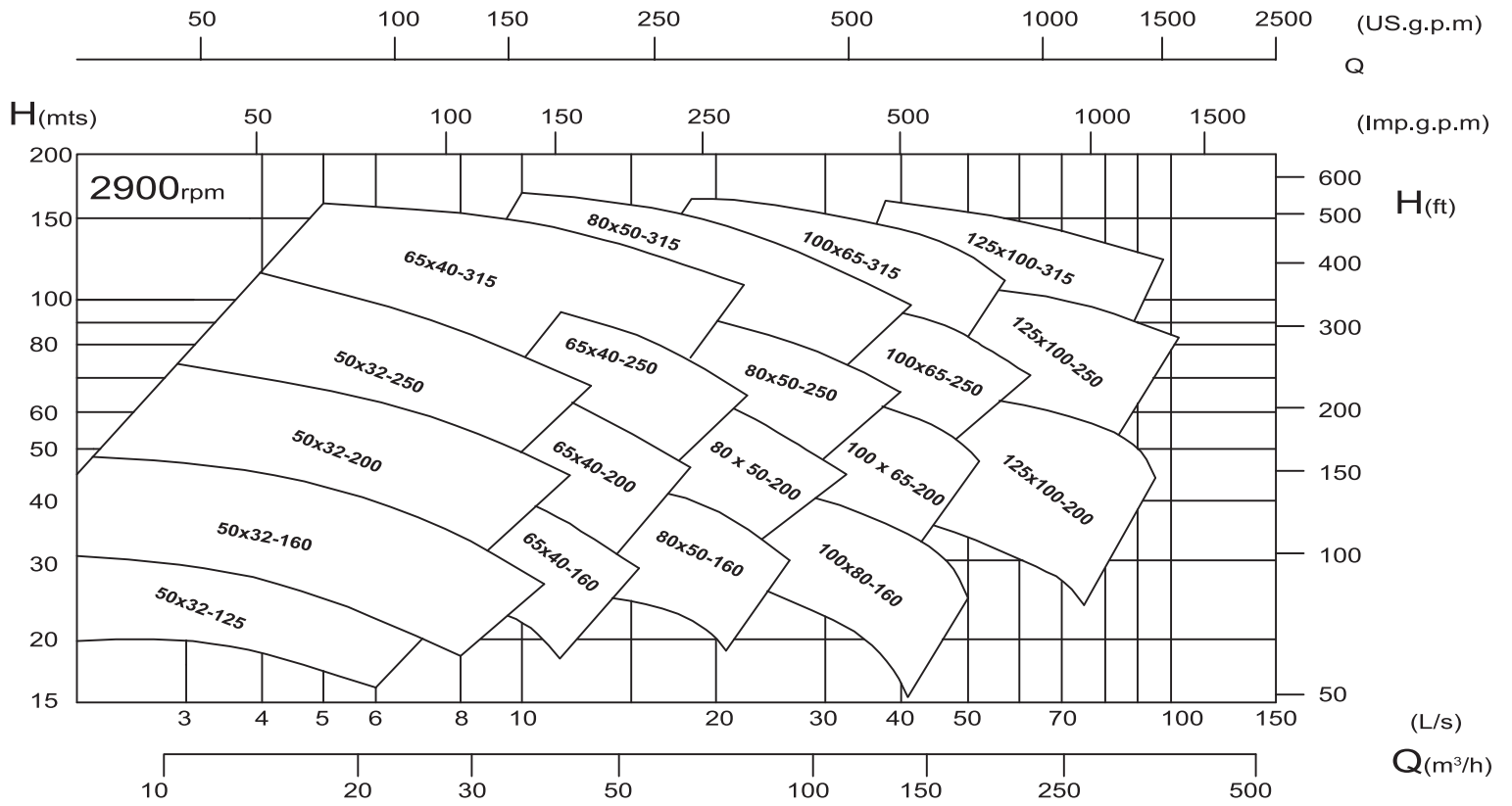

Cross Sectional Drawing

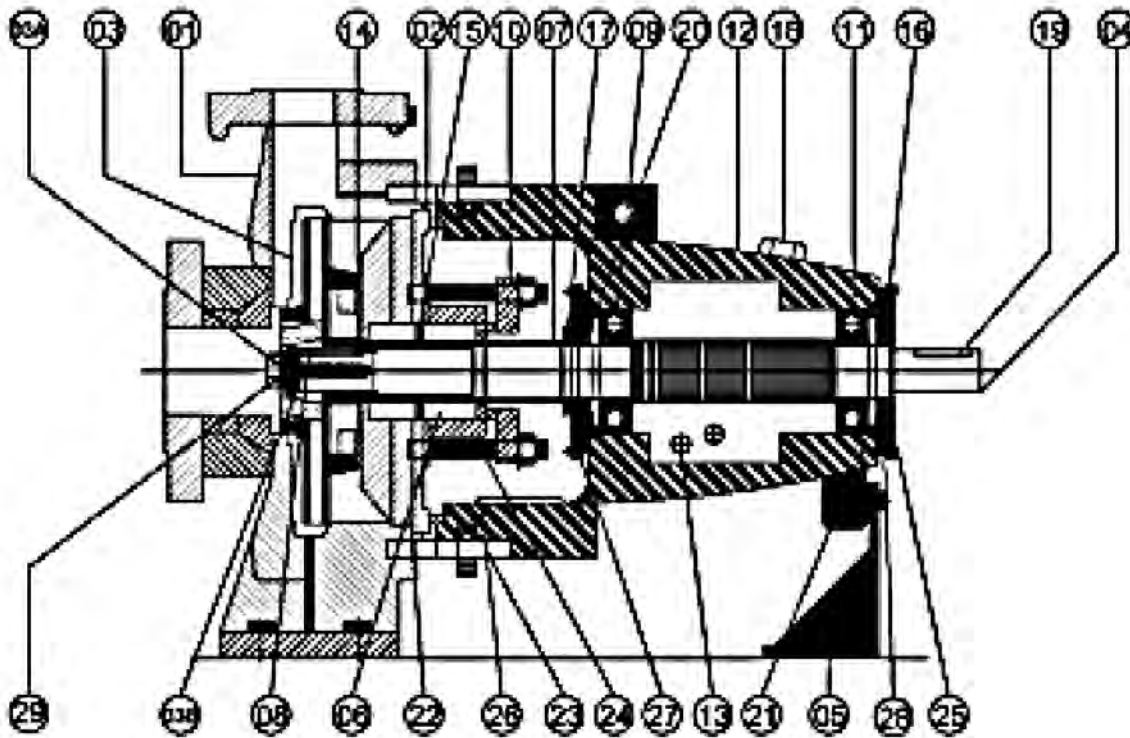

Part No.	Description	Standard Material						
		CS	CF8M	CF3M	CD4MCu	A-20	HC	HB
01	Casing	CS	CF8M	CF3M	CD4MCu	A-20	HC	HB
02	Stuffing Box / Back Plate	CS	CF8M	CF3M	CD4MCu	A-20	HC	HB
03	Impeller	CS	CF8M	CF3M	CD4MCu	A-20	HC	HB
03A	Impeller Nut	CS	CF8M	CF3M	CD4MCu	A-20	HC	HB
03B	Nut Gasket	PTFE						
04	Shaft	EN-19	SS-316					
05	Support Foot	SGI						
06	Stuffing Box Packing	TIWA / GRAFOIL / PTFE						
07	Shaft Sleeve	SS-316	CF8M	CF3M	CD4MCu	A-20	HC	HB
08	Impeller Key	SS-316						
09	Bearing (Inboard)	Steel						
10	Gland Pusher	CS	CF8M	CF3M	CD4MCu	A-20	HC	HB
11	Bearing (Outboard)	Steel						
12	Bearing Frame	CI						
13	Bearing Oil Drain Plug	Steel						
14	Impeller Seal Ring	PTFE						
15	Lantern Ring	Glass Filled PTFE						
16	Bearing Cover (Outboard)	CI						
17	Deflector	SS-304						
18	Oil Breather	Steel						
19	Key Coupling Side	SS-316						
20	Oil Seal (Inboard)	Buna Rubber						
21	Oil Seal (Outboard)	Buna Rubber						
22	Gasket Casing to Stuffing Box Cover	PTFE						
23	Stud Nut Casing	Steel						
24	Bolt - SBCvr to Gland	Steel						
25	Bolt-Bearing Cover to Bearing Frame	Steel						
26	Drip Tray	SS-304						
27	Bearing Cover (Inboard)	CI						
28	Oil Paper Gasket	Paper Material						
29	O-ring for Impeller Bolt	Viton						

Modular Interchangeability

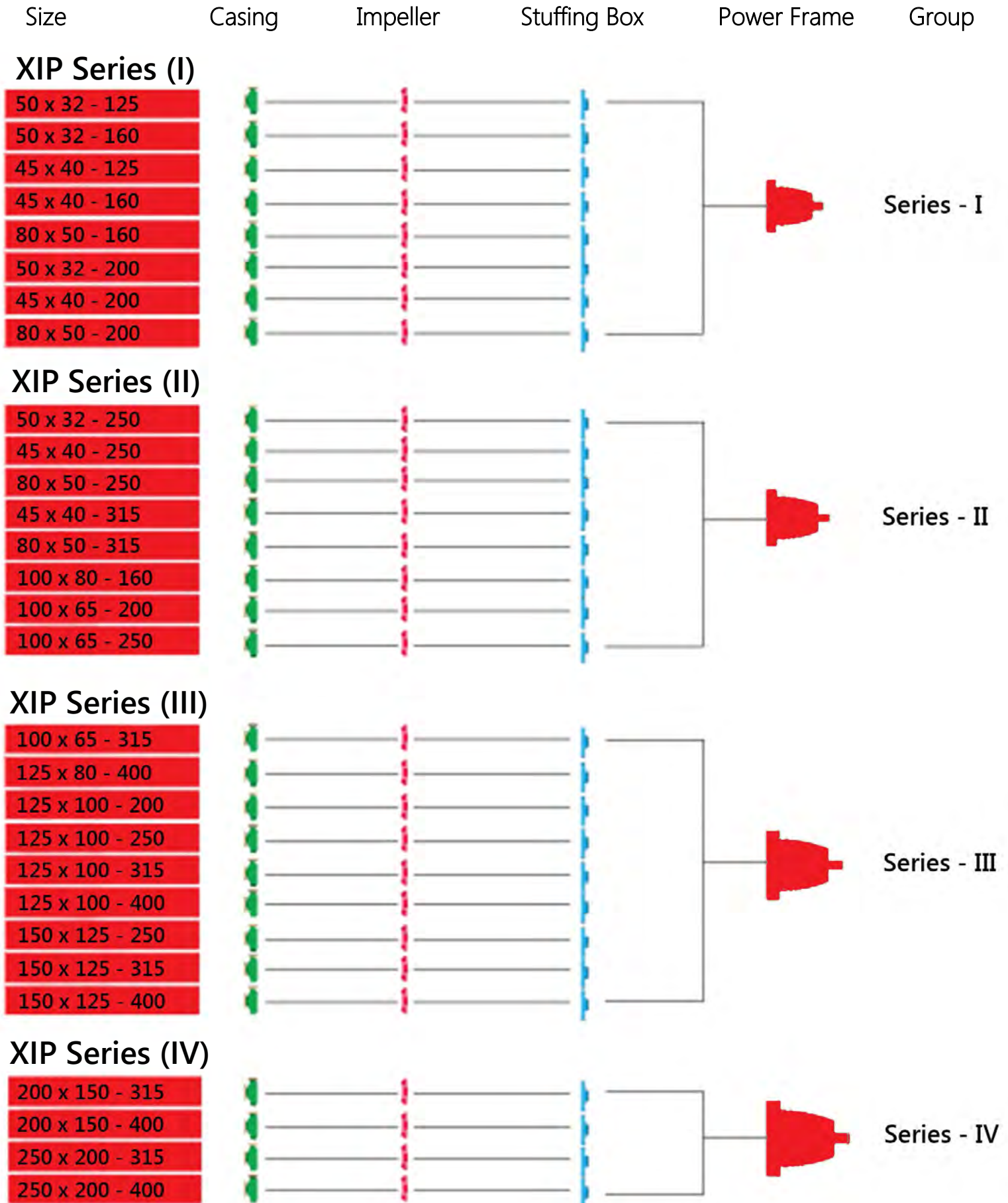

Material Cross Reference Chart

Material	ASTM Casting Grade
Cast Steel	WCB
SS-304	CF8
SS-316	CF8M
SS-316L	CF3M
CD4MCu	CD4MCu
Alloy - 20	CN7M
Carpenter 20	CK-20
Duplex SS	Grade 4A,5A,6A
Hastelloy B	N12MV
Hastelloy C	CW12MW
Nickel (100%)	CZ-100
MONEL	M-35
Ni-Hard	Ni-Hard(Ni-Resistance)
Cast Titanium	B367 Grade C2 / C3

GENERAL APPLICATION INSTALLATION LIST
<p>INDUSTRY</p> <p>Chemical</p> <p>Sulphuric Acid Sodium Hydroxide Hydrochloric Acid Acetic Acid Ammonium Chloride</p>
<p>Petrochemical</p> <p>Benzene Toluene Ammonia Methanol</p>
<p>Pulp & Paper</p> <p>Shower Water White Water Chlorine Dioxide</p>
<p>Brewing</p> <p>Sprage Water Hot / Cold Wort Chilled Water Beer</p>
<p>Primary Metal</p> <p>Copper Cyanide Sodium Cyanide Chromic Acid</p>
<p>General</p> <p>Condensate Deionized Water Shower Water</p>

Applications of Exotic Alloy Pumps

1. Duplex SS (Grade4A,5A,6A): All Sea Water Applications having a good corrosion and abrasion resistance.
2. Alloy 20: All applications of Sulphuric Acid this metal is a Complete winner having wide presence in fields of Paper and Pulp(Alum Transfer), Paint industry, Speciality Chemicals, Battery manufacturing, Pesticides and Fertilisers.
3. Hastalloy B and C: For all highly corrosive applications where there are mixtures of liquids at elevated temperatures. Major Industry it targets is Agro Chemicals.
4. Monel 400: majorly all Applications of Highly corrosive,erosive and abrasive liquids. It works best with various acids, halogens, other corrosive mixtures. It contains 65% of Nickel for tackling majority of aggressive chemicals.
5. 100% Nickel: for Caustic Transfer Applications at elevated temperatures. Major Industry- Caustic Soda Plants.
6. CD4MCu and Ni- Hard: These materials are used where the liquid is Highly abrasive in nature. With high amount Chrome content the above Properties can be achieved. Major industries would be Mineral Processing for CD4MCu and Ni Hard is widely used for handling Ash Handling Slurries in Blast Furnace Operations of Hot Rolling Mills in Steel Plants.



XTF Corporation

7105 Cessna Drive
Greensboro, NC 27409
Phone: (336) 664-9225
Fax: (336) 664-1353

www.XTFco.com

* Dimensions and technical details are subject to change without prior notice.